

<b>718003</b>	DRG	BR 50	=		N
---------------	-----	-------	---	--	---

<b>718083</b>			=		N
---------------	--	--	---	--	---

Pos. Nr. Pos.no.	Beschreibung Description	Art.-Nr. Art.no.	Preisgruppe Price bracket
1	LOKGEHÄUSE KPL. Betr. Nr. 50 008 Body ass. complete loco Nr. 50 008	10718003	029
2	UMLAUFBLECH Running board	11718003	019
3	LICHTLEITER UNTEN Lower light conductor	00137186	005
4	KLEINTEILE -SATZ Set of small parts	00197181	007
5	GRIFSTANGEN F.TENDER Handrails for tender	00197704	001
6	TENDERGEHÄUSE KPL. Tender body complete	20718003	022
7	STROMABNEHMEREINSATZ KPL Power pick-up assembly	00607181	013
8	FLUTLICHTLEITER (TENDER) Light conductor (tender)	00237186	005
9	TENDERBESCHWERUNG Ballast (tender)	00267181	014
10	LOKFAHRGESTELL KPL. Loco chassis complete	30718003	040
11	LOKFAHRGESTE. M.RÄDER F.718002 Loco chassis complete	31718002	033
12	STEUERUNG KPL. Reversing gear complete	00327184	028
13	DECKPLATTE UNTEN Lower cover plate	00337181	006
14	KUKU-DEICHSEL Short coupling reception	00347181	005
15	VORLAUFGESTELL KPL. Set of carrying wheels	00377181	017
16	ZYLINDERKASTEN KPL. Cylinder box complete	48718003	019
17	RADSATZ VOR-U.NACHLAUFGESTELL Carrying wheelset complete	00537030	011
18	LAMPENHALTER MIT BELEUCHTUNGSF. Lamp support with light contact spring	00637181	011
19	LINSENSCHRAUBE M 1,6 X 2-4.8 H Button screw M 1,6 x 2-4.8 H	00704902	002
20	LINSENSCHRAUBE Button screw	00704904	002
21	BLECHSCHRAUBE M.KREUZSCHLITZ Tapping screw	00713309	001
22	BOLZEN F. KUPPELSTANGE Bolt for coupling rod	00730570	001
23	BOLZEN F.KUPPELSTANGE Bolt for coupling rod	00730562	002
24	STECKPUFFER (GEWÖLBT) Plug-in buffer (curved)	00757012	002
25	STECKPUFFER (FLACH) Plug-in buffer (flat)	00757012	002
26	DRUCKFEDER Pressure spring	00767012	001
27	ERS.-GLUEHLAMPE KLAR M.STECKFA Replacement bulb, clear, with socket	00006535	008
<b>Digital</b>			
28	LOKGEHÄUSE KPL. Body ass. complete	10718083	029
29	TENDERGEHÄUSE KPL. Tender body complete	20718083	022
30	LOKFAHRGESTELL KPL. Loco chassis complete	30718083	040
31	LAMPENHALTER MIT BELEUCHTUNGSF. Lamp support with light contact spring	00637182	011

Änderungen in Konstruktion und Ausführung vorbehalten  
We reserve the right to change the construction and specification

**718003** DRG BR 50 = = N

**718083** = = N

Pos. Nr. Pos.no.	Beschreibung Description	Art.-Nr. Art.no.	Preisgruppe Price bracket
1	ADAPTER F.DAMPFLOKS Adaptor	00387003	007
2	TENDERFAHRGESTELL O.MOTOR Tender chassis complete w/o motor	00407181	035
3	TENDERFAHRGESTELL M. ZAHNRAD Tender chassis with gear wheel	00417181	020
4	TENDERDECKPLATTE UNTEN Lower cover plate for tender	00437181	006
5	MOTOR Motor	00507181	028
6	KOHLHALTER Brush holder	00507801	001
7	TENDERRAD O.ZAHNRAD.M.HAFTR. Tender wheels. w/o gearwheel,w/trac.tyre	00517003	006
8	TENDERRAD M.ZAHNRAD.M.HAFTR. Tender wheels. w.gearwheel, w/tract. tyre	00517004	006
9	TENDERRAD O.ZAHNRAD.O.HAFTR. Tender wheels.w/o gearwheel,w/o tr. tyre	00517013	007
10	TENDERRAD M.ZAHNRAD.O.HAFTR. Tender wheels. w.gearwheel,w/o tr. tyre	00517017	007
11	KUPPELRAD Coupled wheel	00517062	007
12	TREIBRAD LI. Left driving wheel	00517072	008
13	TREIBRAD RE. Right driving wheel	00517073	008
14	KUPPELRAD Coupled wheel	00517074	008
15	ACHSE Axle	00527007	001
16	HAFTREIFEN Traction tyre	00547001	001
17	ZAHNRAD Gear wheel	00567104	003
18	ZAHNRAD Z:14/22 Gear wheel Z=14/22	00567113	002
19	ZAHNRAD Gear wheel	00567147	006
20	SCHNECKE Worm gear	00567601	007
21	TENDERRAHMEN KPL. Tender framework complete	00217181	022
22	ENTSTOERDROSSEL Suppressor choke	00644101	007
23	SCHALTPLATTE TEND.KPL. Switch plate complete for Tender	00657095	018
24	SCHALTLEITZE Connecting cable	00667000	009
25	SCHALTLEITZE Connecting cable	00667001	009
26	SCHRAUBE M 1,4 X 3 Screw M 1,4 x 3	00700203	001
27	SENKCHR.F.MOTOR Countersunk screw for Motor	00702908	001
28	BOLZEN F. ZAHNRAD Bolt for gear wheel	00730504	002
29	ERSATZ SCHLEIFKOHLEN Carbon brushes set	6518	---
30	STANDARD-STECKKUPPLUNG Clip-in coupling	9525	---
31	PROFI-STECKKUPPLUNG Profi clip-in coupling	9545	---
<b>Digital</b>			
32	HALTEBLECH Sheet metal support	00627182	003
33	LOKEMPFAINGER DCC DCC decoder	68718482	041
34	TENDERRAHMEN KPL. Tender framework complete	21718082	022
35	TENDERFAHRGESTELL O.MOTOR Tender chassis complete w/o motor	40718082	035
36	MOTOR Motor	00507182	028

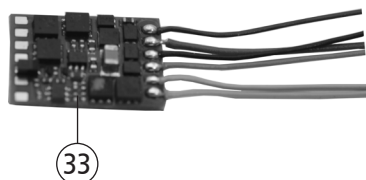
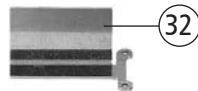
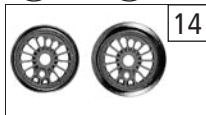
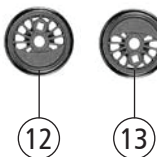
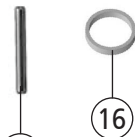
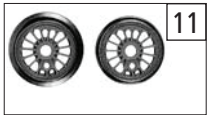
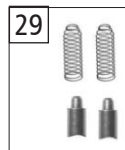
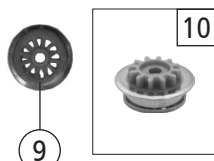
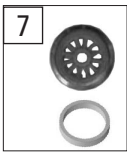
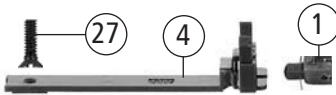
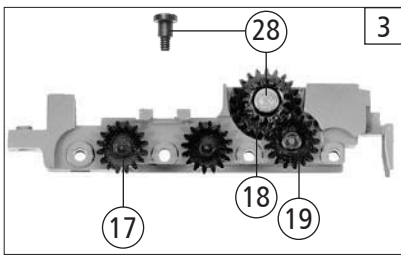
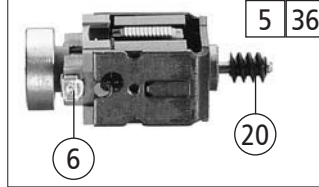
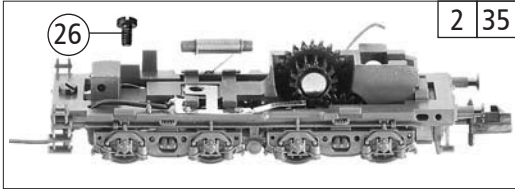
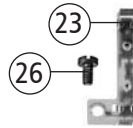
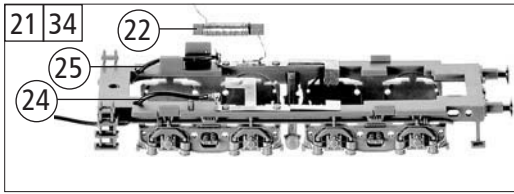

Ersatzteile erhalten Sie direkt unter [www.fleischmann.de](http://www.fleischmann.de), bei Ihrem Fachhändler oder Ihrer Landesvertretung.  
Spare parts can be ordered directly at [www.fleischmann.de](http://www.fleischmann.de) and from your local dealer or country representative.